

RENZ®

BINDING AND LAMINATING SYSTEMS

NEW
The easiest way of
ring wire binding.



New generation of punch
and manual closing machine for
ring wire binding and RENZ RING WIRE®

SRW 360 eco S 360

manually operated punch
and closing machine

SRW 360 comfort eco 360 comfort

electric punch and
manual closing machine



**QUALITY -
MADE IN GERMANY**

FEATURES

- [+] Designed to give the most efficient workflow.
- [+] The modular construction of the **new SRW 360 / Eco S 360** can be upgraded to make an electric punch and manual closing machine, simply by attaching an electric punching module.
- [+] Compact construction with high stability.
- [+] Best ratio of punching pressure.
- [+] Worldwide first ring wire closing unit for diameters up to 38 mm = 1 1/2".
- [+] Working width up to 360 mm.

OFFICE LINE

WORKFLOW

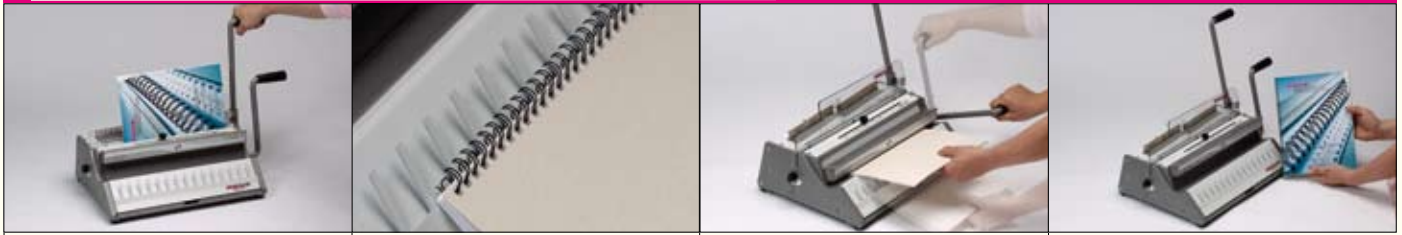

Vertical punching - whether using manual or electric machine.

These punched sheets are inserted onto the ring wire binding element.

The complete brochure can now be easily moved into the closing device for closing.

Pull lever then release. Easiest way of ring wire binding!

MODULAR ASSEMBLY UPGRADE

Fast and easy change of the new SRW 360 / eco S 360 in only 3 minutes from a manual operated machine into a combined electric punch and manual closing machine.



SRW 360 / eco S 360

Remove the cover plate on the rear side of the machine.

+



Electric module

Insert and fasten the electric module. Refit the cover plate.

=



SRW 360 comfort / eco 360 comfort

In only 3 minutes changed from a manual to combined electric punch and manual closing machine.

SPECIFICATIONS - AT A GLANCE

	SRW 360	SRW 360 comfort	eco S 360	eco 360 comfort
length, width, height	58, 33, 15 cm	58, 42, 15 cm	58, 33, 15 cm	58, 42, 15 cm
weight	19 kg	31 kg	19 kg	31 kg
disengageable punch pins	yes [all]	yes [all]	yes [all]	yes [all]
punching thickness	up to 2,5 mm/25 sheets*	up to 2,5 mm/25 sheets*	up to 3 mm/30 sheets*	up to 3 mm/30 sheets*
adjustable margin control	yes	yes	yes	yes
binding thickness	up to 12 mm/120 sheets*	up to 12 mm/120 sheets*	up to 34 mm/340 sheets*	up to 34 mm/340 sheets*
Ø of the wire elements	3/16" - 9/16" 5,5 - 14,3 mm	3/16" - 9/16" 5,5 - 14,3 mm	1/4" - 1 1/2" 6,9 - 38 mm	1/4" - 1 1/2" 6,9 - 38 mm
binding capacity	up to 250 books/h	up to 280 books/h	up to 250 books/h	up to 280 books/h
max. binding width	up to max. 360 mm	up to max. 360 mm	up to max. 360 mm	up to max. 360 mm
number of punch pins	42	42	28	28
pitch	3:1	3:1	2:1	2:1
number of loops on A4 size	34	34	23	23
punching capacity	up to 5.000 sheets/h	up to 10.000 sheets/h	up to 5.000 sheets/h	up to 10.000 sheets/h
motor	modular assembly	230 V / 50 Hz	modular assembly	230 V / 50 Hz
packing	Wire Pack	Wire Pack	Wire Pack up to 1" Plister 1 1/8" - 1 1/2"	Wire Pack up to 1" Plister 1 1/8" - 1 1/2"

Order No. A 4 size 494 720390 (0907)
Order No. US size 494 750390 (0907)

* 70/80 g/m² paper